

Automatic Cleaning and Disinfection Dispenser For toilet with a concealed cistern Installation Instructions

Package contents



Safety points

1. Keep out of reach of children
2. To be used only with Liquid soap (not intended for high acidity liquids)
3. Maximum bottle size for dispenser - 750ml
4. Visible result in toilet bowl will appear within an hour of installation
5. **No touching/squeezing needed - dispenser is fully automatic !**
6. Dispenser should not be left empty of cleaning products for long periods

Installation instructions

installation by a professional plumber

- 1** Remove the push button panel as well as the inner cover
Insure that there aren't any pipes or other devices under the drill spot (A)!
 Use a marker to draw a horizontal line (D), line it up with the bottom of the push button panel. Mark a spot to drill a hole (A) relative to the push button panel (see illustration)
Insure that the drill point is placed above the water level in the cistern !

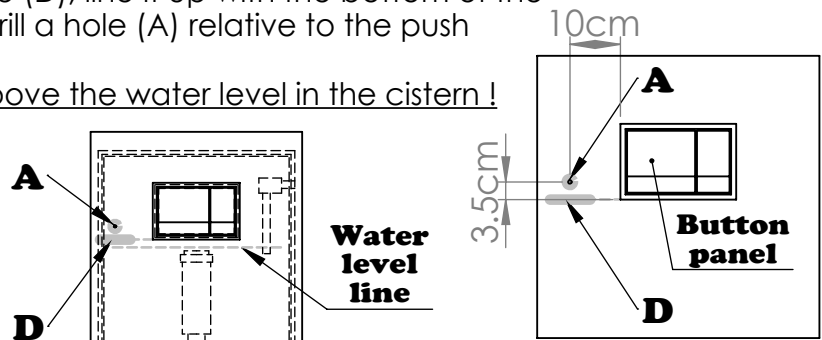

- 2** Drill a 7 millimeter hole (A) without vibration, Make sure that the hole is completely clean

- 3** Insert the tube (C) into the hole (A) ensure that it enters the cistern
 Remove it and set the dispenser aside

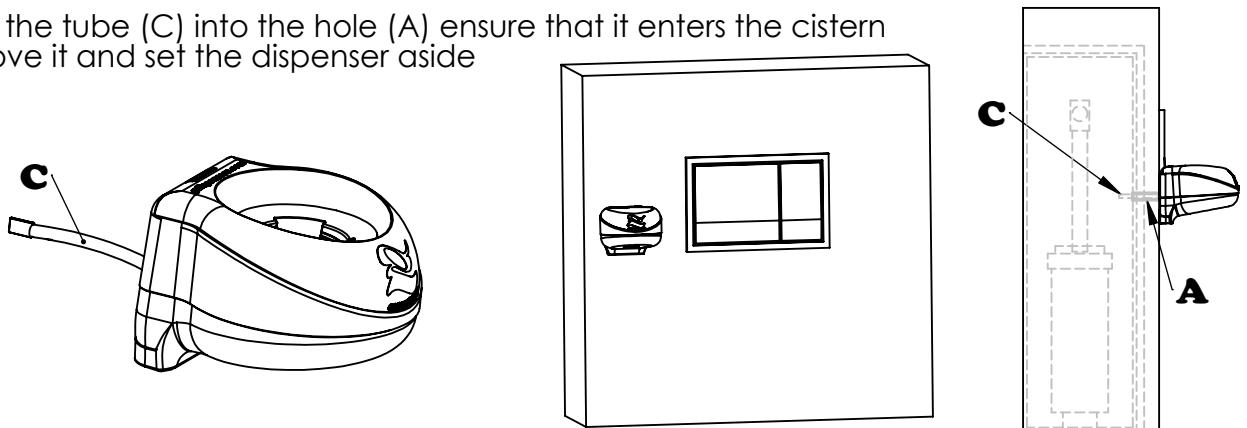

- 4** Carefully clean the area of oils and dirt and dry thoroughly

- 5** Verify that the tube (C) is in the upper position and that the Dropper (5) is attached

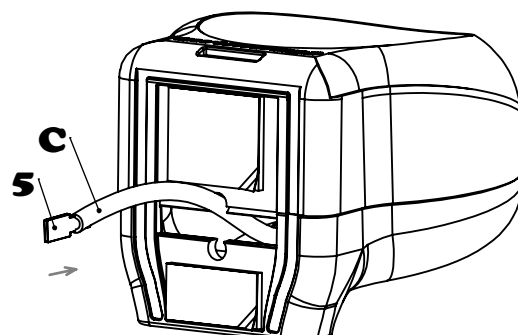

Continue...

Automatic Cleaning and Disinfection Dispenser For toilet with a concealed cistern Installation Instructions

- 6** Remove the seal of the double sided tape from the two stickers (E) at the back of the dispenser

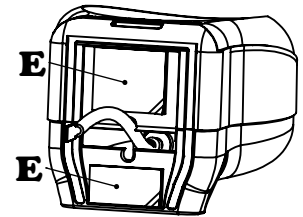

- 7** Open the tube of glue (included in the package) and dispense the content evenly on the track (F) at the back of the dispenser
The glue tube should be kept in a dark place at temperature between 5-25 degrees celsius

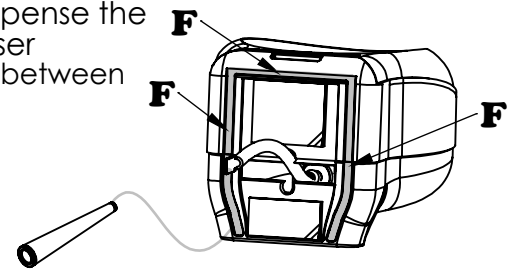

- 8** Verify that the tube (c) is in the upper position and that the Dropper (5) is attached. Insert tube (c) into the hole (A) and press the dispenser into place based on the mark (D)
Press and apply strong pressure for 10 seconds !

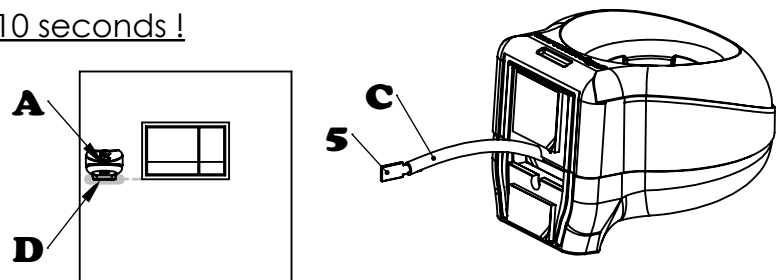

- 9** **You must allow 24 hours to completely dry prior to loading a disposable bottle !**
a bottle should not be installed until the glue has completely dried

Loading the dispenser and cap replacement for disposable bottle (first loading after 24 hours)

1. Remove the cap from the purchased bottle
2. Install the dispenser cap (2) included in the package to the bottle
3. To Load the bottle onto the dispenser the bottle should be tilted and inserted fully in place
4. **To replace the bottle, the bottle should be tilted and removed from the dispenser**
5. **Usage instructions: No touching/squeezing needed - dispenser is fully automatic !**

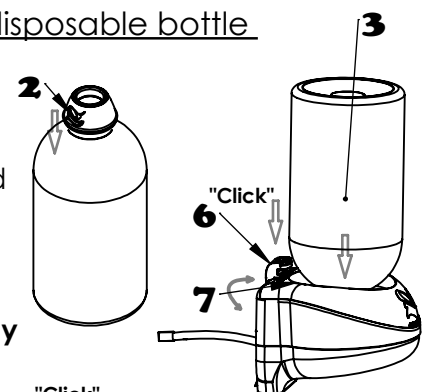

Use of Bottle Lock (Optional)

6. Insert the fixed part of the bottle lock into the slot on the dispenser (6)
7. After loading the bottle, attach the movable part of the bottle lock (7) to the dispenser cap and turn it right or left until it locks into the fixed part of the lock



For installation videos and placing orders please visit our website

gdispensers.com